

# Condiment Unit

Open and Lockable / HC Storage and Lockable

**Product#** C006.02 / C006.03

The Condiment Units can be used for all of your storage needs. These units are mobile and can be used anywhere safe storage is needed. The open and lockable Condiment Unit is composed of an open shelf side and a lockable door side. The High Chair Storage and Lockable Condiment Unit option is composed of one fully open side.



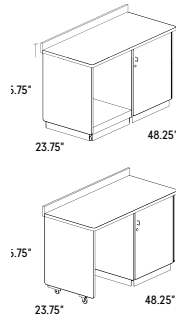

**Features**

*Vinyl edgebanded for maximum durability*

*Durable metal door handles*

*Lockable doors*

*Castors for easy relocation*

*Left or right configurations available*

**Standard Specs**

**Components**

Laminated Engineered Plywood  
Steel  
Edgebanding

**Sizes**

48.25" w x 23.75" d x 35.75" h

**Finishes/Color**

Support:



Unit (one of each):

Laminate



Edgeband



Top options:

Solid Surface



Laminate



See "Finishes" section for larger samples and order codes.

Available in additional colors upon request.

